

Terminals: Tin plated leads, solderable per J-STD-002 and JESD22-B102

Polarity: As marked

Maximum Ratings ($T_a=25$ Unless otherwise specified)

PARAMETER	SYMBOL	UNIT	MBR20300CT
Device marking code			MBR20300CT
Repetitive Peak Reverse Voltage	VRRM	V	300
Average Rectified Output Current @60Hz sine wave, R-load, $T_a=25$	IO	A	20
Surge(Non-repetitive)Forward Current @60Hz half sine-wave, 1 cycle, $T_a=25$	IFSM	A	200
Current Squared Time @1ms $t < 8.3ms$ $T_j=25$	I^2t	A^2s	167

--	--	--	--

Electrical Characteristics ($T_a=25$ Unless otherwise specified)

PARAMETER	SYMBOL	UNIT	TEST CONDITIONS	MBR20300CT
Maximum instantaneous forward voltage drop per diode	VFM	V	IFM=10.0A	0.975
Maximum DC reverse current at rated DC blocking voltage per diode	I _{RRM1}	mA	VRM=VRRM $T_a=25$	0.05
	I _{RRM2}		VRM=VRRM $T_a=100$	10



MBR20300CT

Thermal Characteristics $T_a=25$ Unless otherwise specified

PARAMETER		SYMBOL	UNIT	MBR20300CT
Thermal Resistance	Between junction and case	R_{j-c}	$^{\circ}W$	2.0

Ordering Information (Example)

PREFERRED P/N	UNIT WEIGHT(g)	MINIMUM PACKAGE(pcs)	INNER BOX QUANTITY(pcs)	OUTER CARTON QUANTITY(pcs)	DELIVERY MODE
MBR20300CT	Approximate 1.9	50	1000	5000	Tube

Characteristics (Typical)

FIG1:Io -Tc Curve

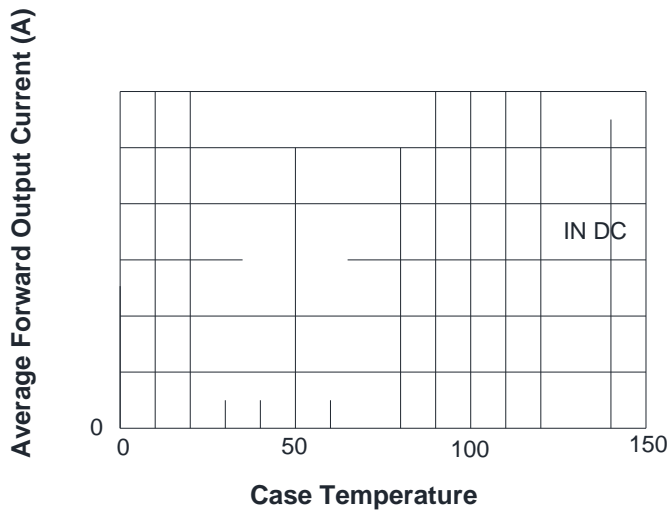



Outline Dimensions

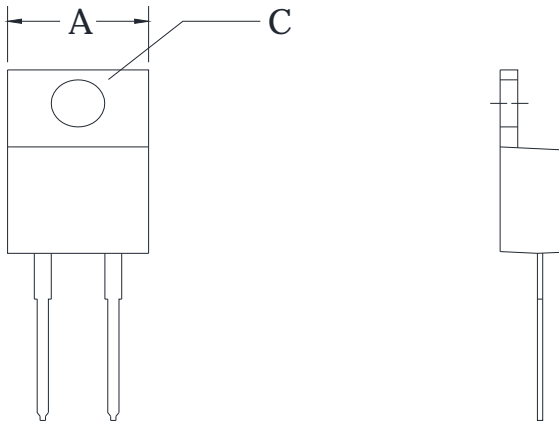

MBR20300CT
